

100
Millimetres
0 10
DO NOT SCALE

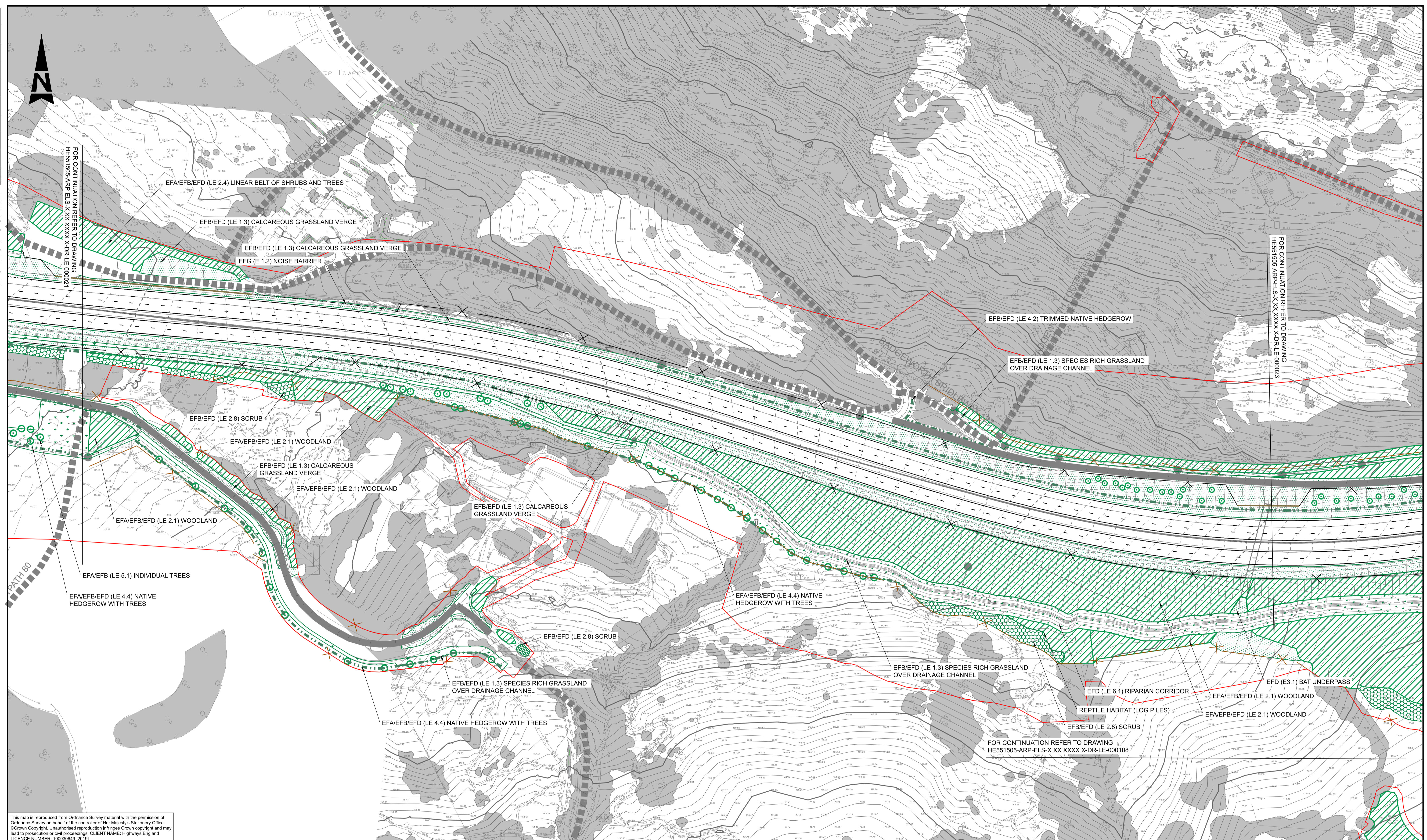

This map is reproduced from Ordnance Survey material with the permission of Ordnance Survey on behalf of the controller of Her Majesty's Stationary Office. © Crown Copyright. Unauthorised reproduction infringes Crown copyright and may lead to prosecution or civil proceedings. CLIENT NAME: Highways England LICENCE NUMBER: 100030949 (2019)

| LEGEND | | KEY VIEWS | | MAJOR CONTOUR | |
|--------|--|-----------|-------------------------|---------------|---|
| | EXISTING WOODLAND RETAINED | | KEY VIEWS | | MAJOR CONTOUR |
| | BROADLEAVED WOODLAND PROPOSED | | PROW PROPOSED | | MINOR CONTOUR |
| | WOODLAND EDGE/SCRUB PROPOSED | | PROW EXISTING | | PROPOSED CONTOUR |
| | SPECIMEN TREE PROPOSED | | EMBANKMENT | | DCO BOUNDARY |
| | NATIVE HEDGEROW PROPOSED | | CUTTING | | VEGETATION TRANSPLANT SITE |
| | LIMESTONE GRASSLAND PROPOSED | | LANDSCAPE EARTHWORKS | | BADGER FENCING |
| | SPECIES RICH GRASSLAND PROPOSED | | ENVIRONMENTAL BARRIER | | HIGHWAYS FENCING |
| | ROCK FACE LEFT TO NATURALLY REGENERATE WITH VEGETATION | | ACOUSTIC FENCE | | PROPOSED FIELD GATE WITH BADGER PROOF FENCING |
| | DRY STONE WALL | | ECOLOGICAL INTERVENTION | | |

| SAFETY, HEALTH AND ENVIRONMENTAL INFORMATION | |
|--|--|
| IN ADDITION TO THE HAZARDS/RISKS NORMALLY ASSOCIATED WITH THE TYPES OF WORK DETAILED ON THIS DRAWING, NOTE THE FOLLOWING SIGNIFICANT RESIDUAL RISKS (REFERENCE SHALL ALSO BE MADE TO THE DESIGN HAZARD LOG). | |
| CONSTRUCTION | |
| Risk ID 777 Buried services in tree pit excavations. | |
| Risk ID 778 Risk of injury from vegetation clearance | |
| Risk ID 782 Heavy loads when constructing dry stone walls | |
| Risk ID 799 Adversity during vegetation clearance | |
| MAINTENANCE / CLEANING | |
| Risk ID 779 Moving vehicles and maintaining vegetation | |
| Risk ID 822 Maintenance machinery tipping on slopes | |
| USE | |
| NONE | |
| DECOMMISSIONING / DEMOLITION | |
| NONE | |

| Rev. | Date | Description | By | Chk'd | App'd | Auth'd |
|------|----------|-----------------------------------|----|-------|-------|--------|
| C01 | 21/05/21 | APPLICATION SUBMISSION (MAY 2021) | HS | AK | SW | YB |

Suitability Drawing Status
A3 STAGE COMPLETED

Client

| Project Title | | Drawing Title | |
|----------------------|----------------------|--|----------------------|
| A417 MISSING LINK | | FIGURE 7.11 ENVIRONMENTAL MASTERPLAN REG 5(2)(O) SHEET 3 OF 25 | |
| Scale | By | Checked | Approved |
| 1:1000 | HS | AK | SW |
| Original Size | Date | Date | Date |
| A1 | 21/05/21 | 21/05/21 | 21/05/21 |
| Authorised | Authorised | Authorised | Authorised |
| YB | YB | YB | YB |
| Volume | Volume | Volume | Volume |
| HE551505 - ARP - ELS | HE551505 - ARP - ELS | HE551505 - ARP - ELS | HE551505 - ARP - ELS |
| X_XX_XXXX_X | X_XX_XXXX_X | X_XX_XXXX_X | X_XX_XXXX_X |
| -DR-LE-000022 | -DR-LE-000022 | -DR-LE-000022 | -DR-LE-000022 |
| Location | Type | Role | Number |
| | | | |
| Drawing Number | Originator | Volume | Revision |
| HE551505 - ARP - ELS | HE551505 - ARP - ELS | HE551505 - ARP - ELS | HE551505 - ARP - ELS |
| X_XX_XXXX_X | X_XX_XXXX_X | X_XX_XXXX_X | X_XX_XXXX_X |
| -DR-LE-000022 | -DR-LE-000022 | -DR-LE-000022 | -DR-LE-000022 |
| C01 | C01 | C01 | C01 |